



Fjords Nordic Sofa



Quick Ship: 3 Seat Sofa DUO, Arm 11 in AL Vintage Cognac.
1 Seat Chair, Arm 11 in AL Vintage Cognac.
All other color combinations must be special order.
Leg Options (Angled or Straight: Espresso, Walnut, Oak, Black, Charcoal)



Quick Ship: Sofa 2.5 Seat Duo + Corner + End Module Right in Nolio 08 with Arm 18
Leg Options: H-Leg in Oak Mocca



Quick Ship: 3 Seat Duo in Woolly 2151 Beige
All other color combinations must be special order.
Leg Options (Angled or Straight: Espresso, Walnut, Oak, Black, Charcoal)

The above options are available as part of our Quick Ship program.
All other options (listed on the next page) are available as a Special Order.

Modules / options - Standard modules for both large and small arrangements

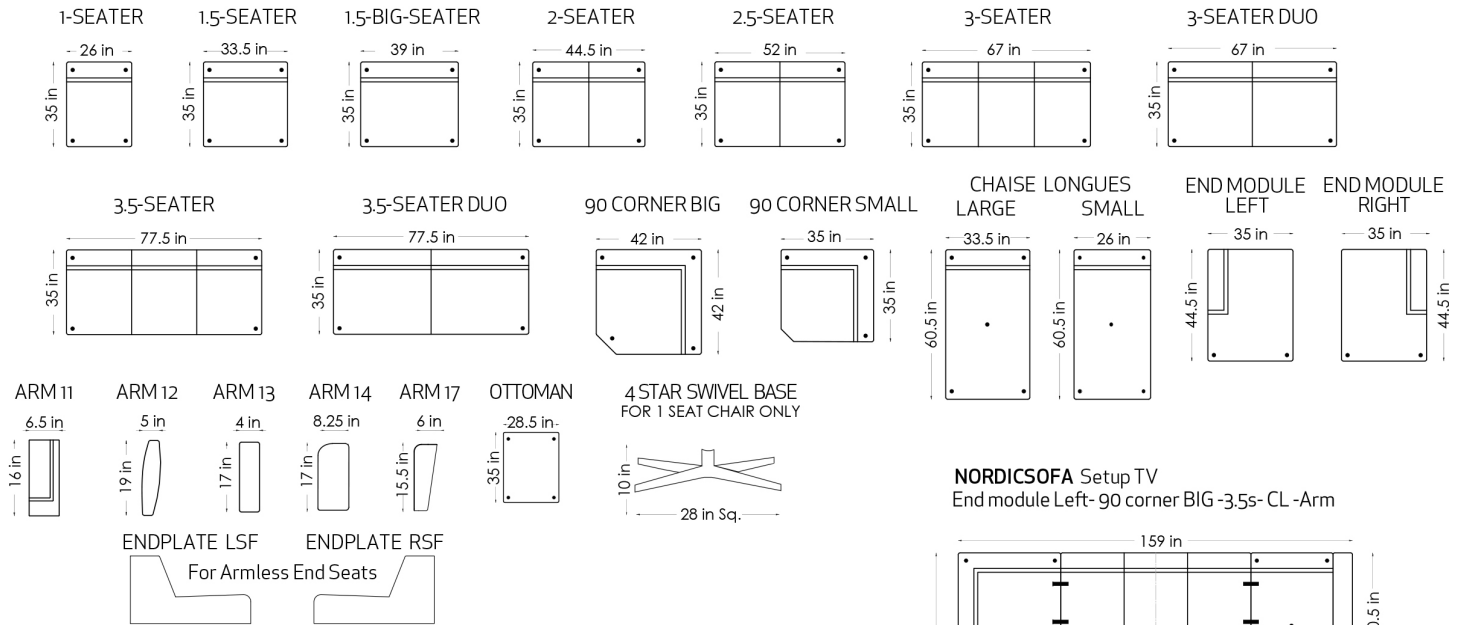

NORDICSOFA Setup B
Arm-2.5 s-90 corner BIG -2.5 s-CL-Arm Reversible

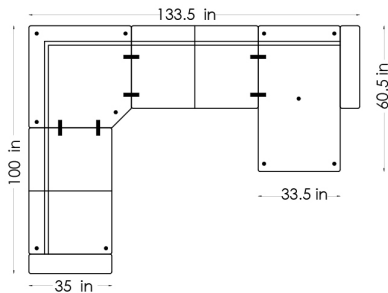

NORDICSOFA Setup E
Arm-3.5 s-CL-Arm Reversible

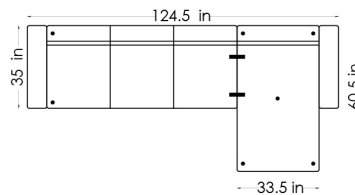

NORDICSOFA Setup RH
Arm-3 s-90 corner BIG -end module Right

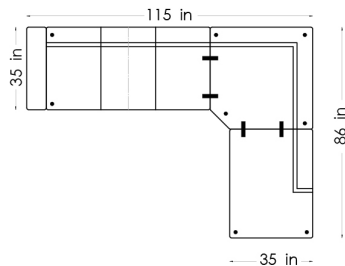

NORDICSOFA Setup H
Arm-3 s-90 corner BIG -1.5 s-Arm Reversible

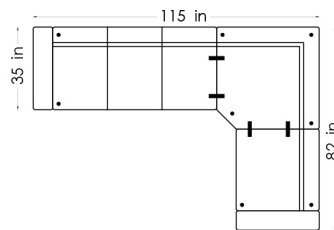

NORDICSOFA Setup TV
End module Left- 90 corner BIG -3.5s- CL-Arm

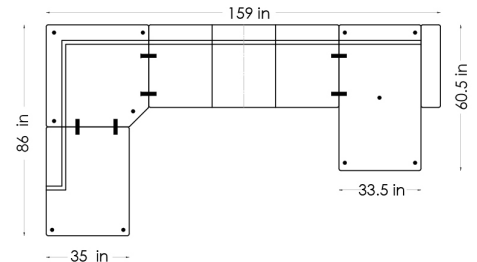

NORDICSOFA Setup F
Arm-2.5 s-90 corner BIG -3 s-Arm Reversible

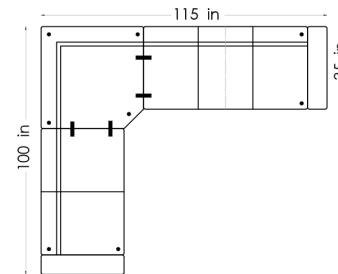

NORDICSOFA Setup L
Arm-3.5 s-90 corner BIG -1.5 Big s-Arm Reversible

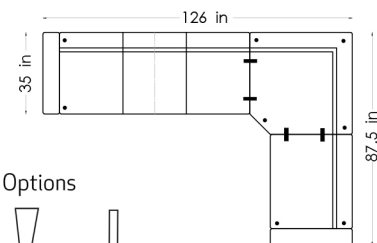

Depth: 35 in
Height: 33 in
Seat height: 18.5 in
Seat depth: 22 in

All measurements are listed with Arm 11 at 6.5 in.
Total size may vary by +/- 1.5 in depending on the thickness of the fabric / leather.

Leg Style Options

